

A, B Series

The A, B Series filters are suited for large capacity industrial electric equipments, such as inverters, power purified, to suppress the electromagnetic interference along power lines. The filters have stronger capacity of simple & economical fighting saturation suitable for use in installation general purpose shielded rooms, as well as movable shielder cabinet containing electronic equipments.

*Technical Data

Rated Voltage	200/380VAC 500VDC
Operating Frequency	50/60Hz
Rated Current	20A-60A
Test Voltage	1000VDC(line/line)
Test Voltage	1000VDC(line/ground)
Climatic Category	25/070/21

M O D E L D L -	R a t e d C u r r e n t (A)	L e a k a g e C u r r e n t ≤ m A	I n s e r t i o n L o s s (M e a s u r e d i n 5 0 Ω)		D i m e n s i o n F I G .
			F r e q u e n c y (H z)	I L (d B)	
3 A	3	0.14	40K ~ 30M	60	2
5 A	5	0.47	100K ~ 30M	80	3
15 A	15	0.32	0.15M ~ 2.4G	70 ~ 100	4
25 A	25	0.32	0.15M ~ 2.4G	70 ~ 100	4
50 A	50	0.32	0.15M ~ 2.4G	70 ~ 100	4
80 A	80	0.32	0.15M ~ 10G	60 ~ 100	1
100 A	100	0.47	0.15M ~ 500M	70 ~ 100	5
200 A	200	0.64	0.15M ~ 500M	70 ~ 100	6
2 × 15 A	15	0.42	0.15M ~ 10G	70 ~ 100	1
2 × 25 A	25	0.46	0.15M ~ 10G	70 ~ 100	1
15 B	15	0.56	0.1M ~ 10G	100	1
25 B	25	0.56	0.1M ~ 10G	100	1

*Outline Drawing and Dimensions:(mm)

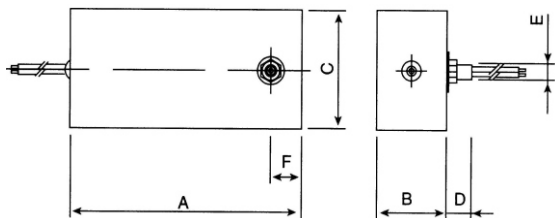

Fig1

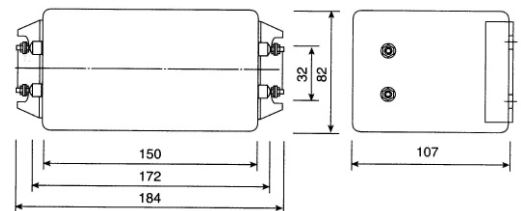

Fig2

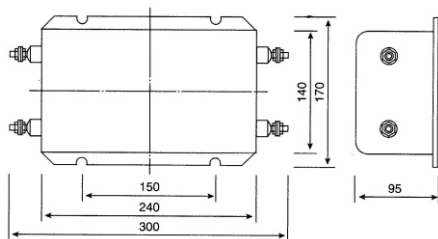

Fig3



Fig4

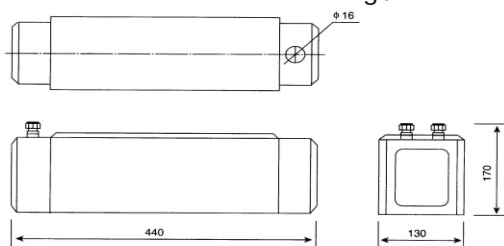

Fig5

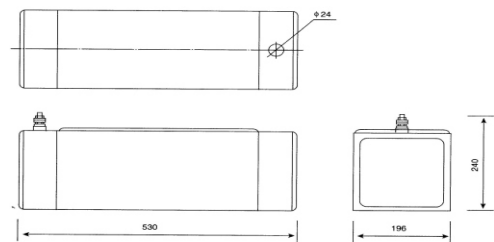

Fig6

M O D E L	A	B	C	D	E	F
D L - 2 X 1 5 A	220	90	120	42	M 16	15
D L 2 - X 2 5 A						
D L - 8 0 A	530	186	196	48	M 24	30
D L - 1 5 B	690	140	110	48	M 16	30
D L - 2 5 B						