



LED DISPLAY

Part Number: KPS-5161BGBD15

Page: 1/3

Rev:00

Package Dimension:

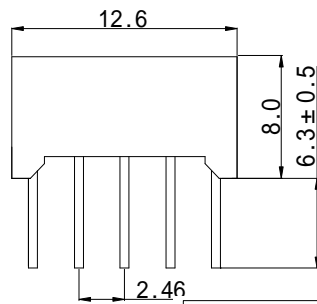
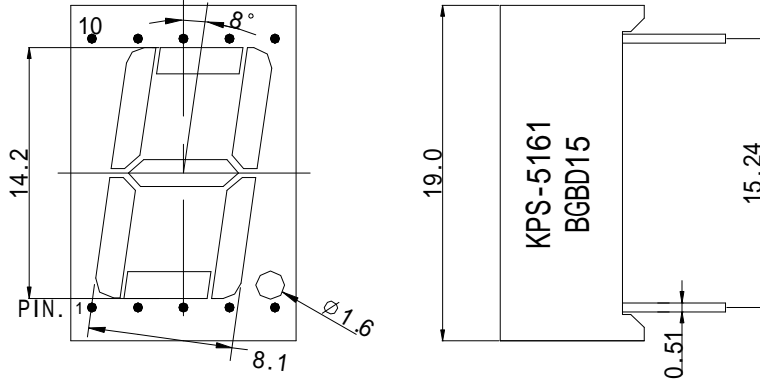

Pin Function

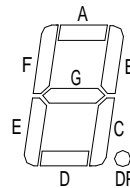

3,8
COM

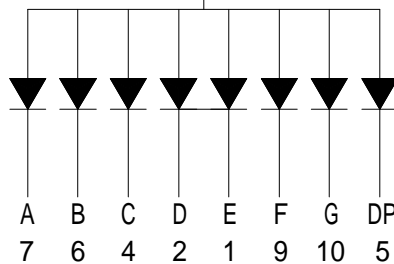

Part Number	Chip		CCorCA
KPS-5161BGBD15	Material	Emitting Color	
	GaP	GREEN	CA

NOTES:

- All dimensions are millimeters(inches)
- Tolerance is 0.25mm(0.01")unless otherwise noted.
- COLLOID COLOR: WHITE
- FACE COLOR: BLACK



LED DISPLAY

Part Number: KPS-5161BGBD15

Page:2/3

Rev:00

1.SPECIFICATIONS

(1) Absolute Maximum Rating/

(Ta=25)

Parameter	Symbol	Absolute Maximum Rating	Unit
Forward Current/	IF	30	mA
Peak Forward Current/	IFP	160	mA
Reverse Voltage /	VR	5	V
Power Dissipation/	PD	100	mW
Electrostatic Discharge /HBM	ESD	/	V
Operating Temperature/	TOP	-40 ~80	
Storage Temperature/	TSTG	-40 ~100	
Lead Soldering Temperature	TSOL	260 FOR 5 SECONDS	

IFP Conditions: Pulse Width 10msec.and duty 1/10

(2) Initial Electrical/Optical Characteristics/

(Ta=25)

Parameter	Symbol	Condition	Min	Typ	Max	Unit
Forward Voltage/	VF	IF=20(mA)	1.7	2.1	2.8	V
Reverse Current/	IR	VR=5(V)	/	/	100	μA
Luminous Intensity/	IV	IF=10(mA)	1500	1800	/	μcd
Peak Wavelength/	p	IF=20(mA)	565	570	575	nm
Spectral width at half height /				10-20	/	nm

2.TYPICAL INITIAL OPTICAL/ELECTRICAL CHARACTERISTICS

Please refer to Figures: Page:3/3

3.OUTLINE DIMENSIONS AND MATERIALS

Please refer to Figures:Page:2/3

Material as follows: Resin :Epoxy



LED DISPLAY

Part Number: KPS-5161BGBD15

Page:3/3

Rev:00

Typical Electro-Optical Characteristic Curves:

Fig1.Forward Current vs.Forward Voltage

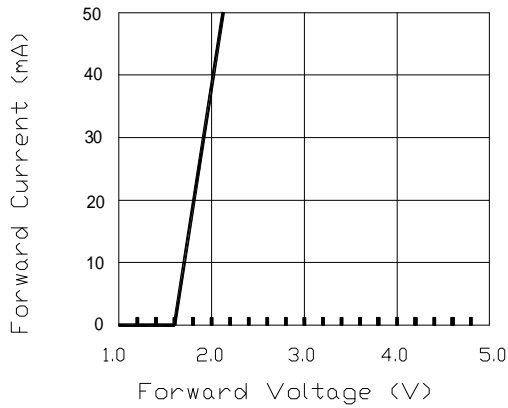

Fig2.Relative Intensity vs. Forward Current

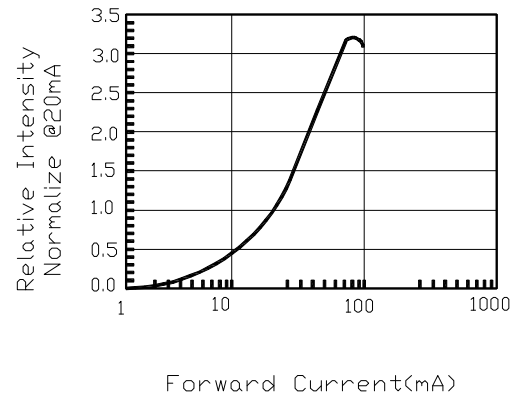

Fig3.Forward Voltage vs. Temperature

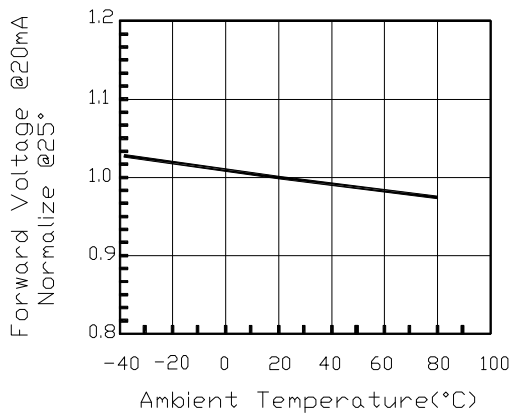

Fig4.Relative Intensity vs. Temperature

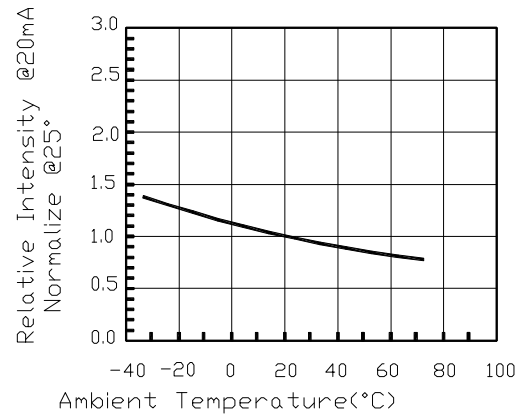

Fig5.Relative Intensity vs. Wavelength

